

NOTES

1. DO NOT SCALE FROM THIS DRAWING, WORK FROM FIGURED DIMENSIONS ONLY. ALL DIMENSIONS ARE IN METRES AND ALL LEVELS ARE IN METRES ABOVE ORDNANCE DATUM UNLESS NOTED OTHERWISE.

2. THIS DRAWING IS TO BE READ IN CONJUNCTION WITH ALL RELEVANT ARCHITECTS, ENGINEERS AND SPECIALIST DRAWINGS AND SPECIFICATIONS.

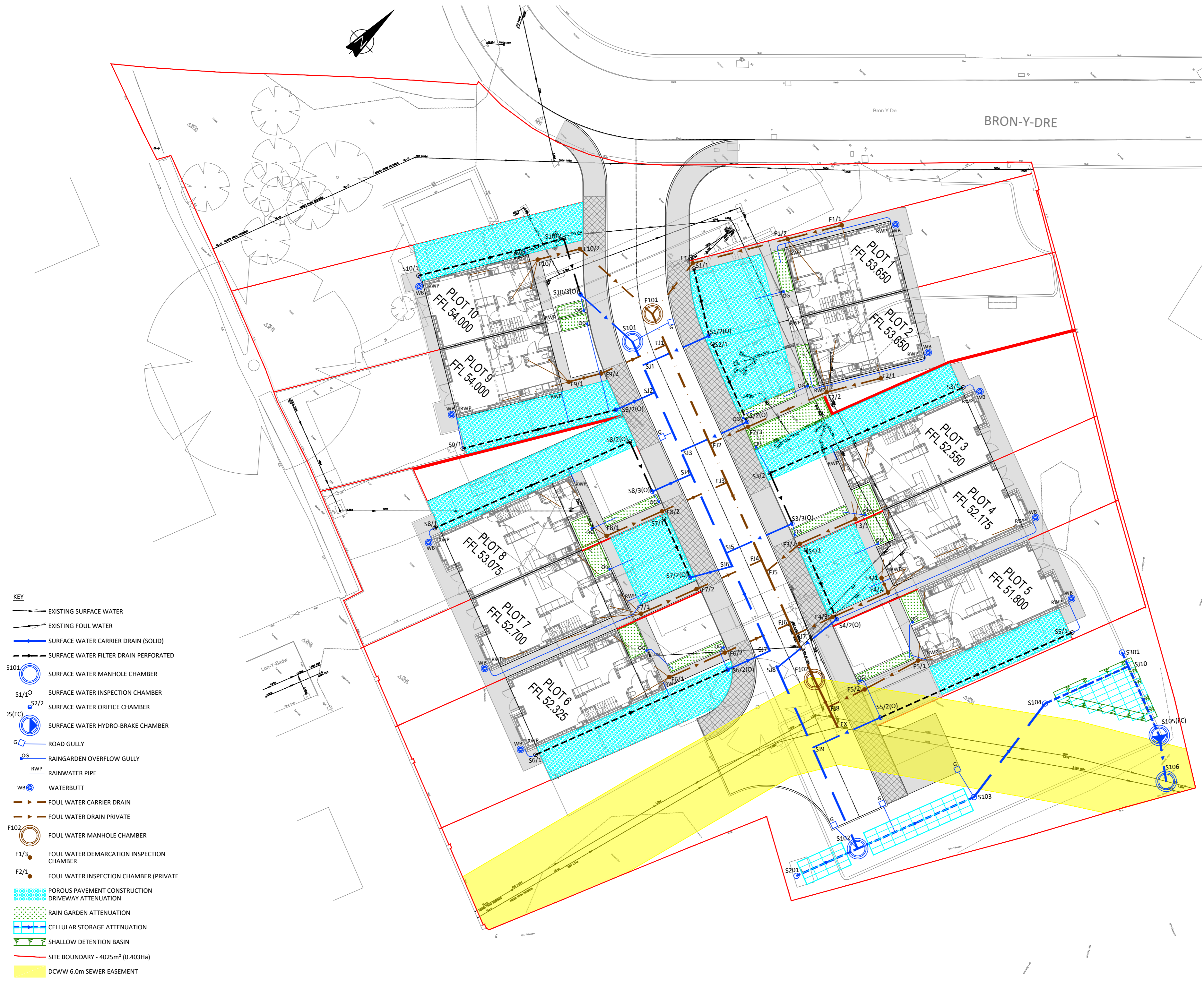

- KEY**
- EXISTING SURFACE WATER
 - EXISTING FOUL WATER
 - SURFACE WATER CARRIER DRAIN (SOLID)
 - SURFACE WATER FILTER DRAIN PERFORATED
 - S101 SURFACE WATER MANHOLE CHAMBER
 - S1/1^o SURFACE WATER INSPECTION CHAMBER
 - S2/2 SURFACE WATER ORIFICE CHAMBER
 - J5(FC) SURFACE WATER HYDRO-BRAKE CHAMBER
 - G ROAD GULLY
 - OG RAINGARDEN OVERFLOW GULLY
 - RWP RAINWATER PIPE
 - WB WATERBUTT
 - FOUL WATER CARRIER DRAIN
 - FOUL WATER DRAIN PRIVATE
 - F102 FOUL WATER MANHOLE CHAMBER
 - F1/3 FOUL WATER DEMARCATION INSPECTION CHAMBER
 - F2/1 FOUL WATER INSPECTION CHAMBER (PRIVATE)
 - POROUS PAVEMENT CONSTRUCTION DRIVEWAY ATTENUATION
 - RAIN GARDEN ATTENUATION
 - CELLULAR STORAGE ATTENUATION
 - SHALLOW DETENTION BASIN
 - SITE BOUNDARY - 4025m² (0.403Ha)
 - DCWW 6.0m SEWER EASEMENT

P02	SAB PRE-APP SUBMISSION	NWO	-	01/03/24
P01	ISSUED FOR COMMENT	NWO	-	28/02/24
REV	MODIFICATIONS	BY	RE	AP DATE
PURPOSE OF ISSUE				STATUS
DRAFT				SO
CLIENT:				
 GWYNEDD COUNCIL				
PROJECT:				
FORMER YSGOL BABANOD COED MAWR BRON-Y-DE BANGOR				
TITLE:				
FOUL AND SURFACE WATER DRAINAGE LAYOUT GENERAL ARRANGEMENT				
DESIGNED BY	DRAWN BY	REVIEWED BY	AUTHORISED BY	
NWO	NWO			
DATE	SCALE @ A2	JOB REF:	REVISION	
23/02/24	1:200	5318	P02	
DRAWING NUMBER				
5318-CAU-XX-XX-DR-C-1600				
 engineering environmental planning				

Registered Office: Intec, Parc Menai, Bangor, Gwynedd, LL57 4FG Company Registered No: 06716319